



# MAIN ENTRANCE

Ceiling height 5,75m

# FW FURNITURE INTERIOR WOODWORKING

Conference hall size 24800x5500mm

# ATAKENT EXHIBITION CENTRE

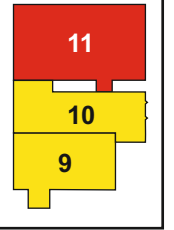

# Pavilion 11

ATAKENT EXHIBITION CENTER  
42, TIMIRYAZEV STR.  
ALMATY, KAZAKHSTAN

- 1 square meter on the floorplan
- Free zone from booth construction
- Pillar 65x55cm
- Fireplug
- Electrical shield
- Signaling button
- Plumbing

Height level to objects

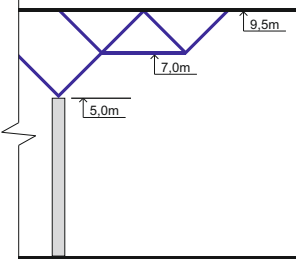

Floor loading 800 kg/m<sup>2</sup>

Нажмите, чтобы заказать эксклюзивный стенд



Click to order Exclusive stand

CABINET FURNITURE, TABLES & CHAIRS, DOORS / КОРПУСНАЯ МЕБЕЛЬ, СТОЛЫ И СТУЛЬЯ, ДВЕРИ

SOFT FURNITURE & INTERIOR / МЯГКАЯ МЕБЕЛЬ И ИНТЕРЬЕР

MATTRESS & TEXTILE / МАТРАСЫ И ТЕКСТИЛЬ

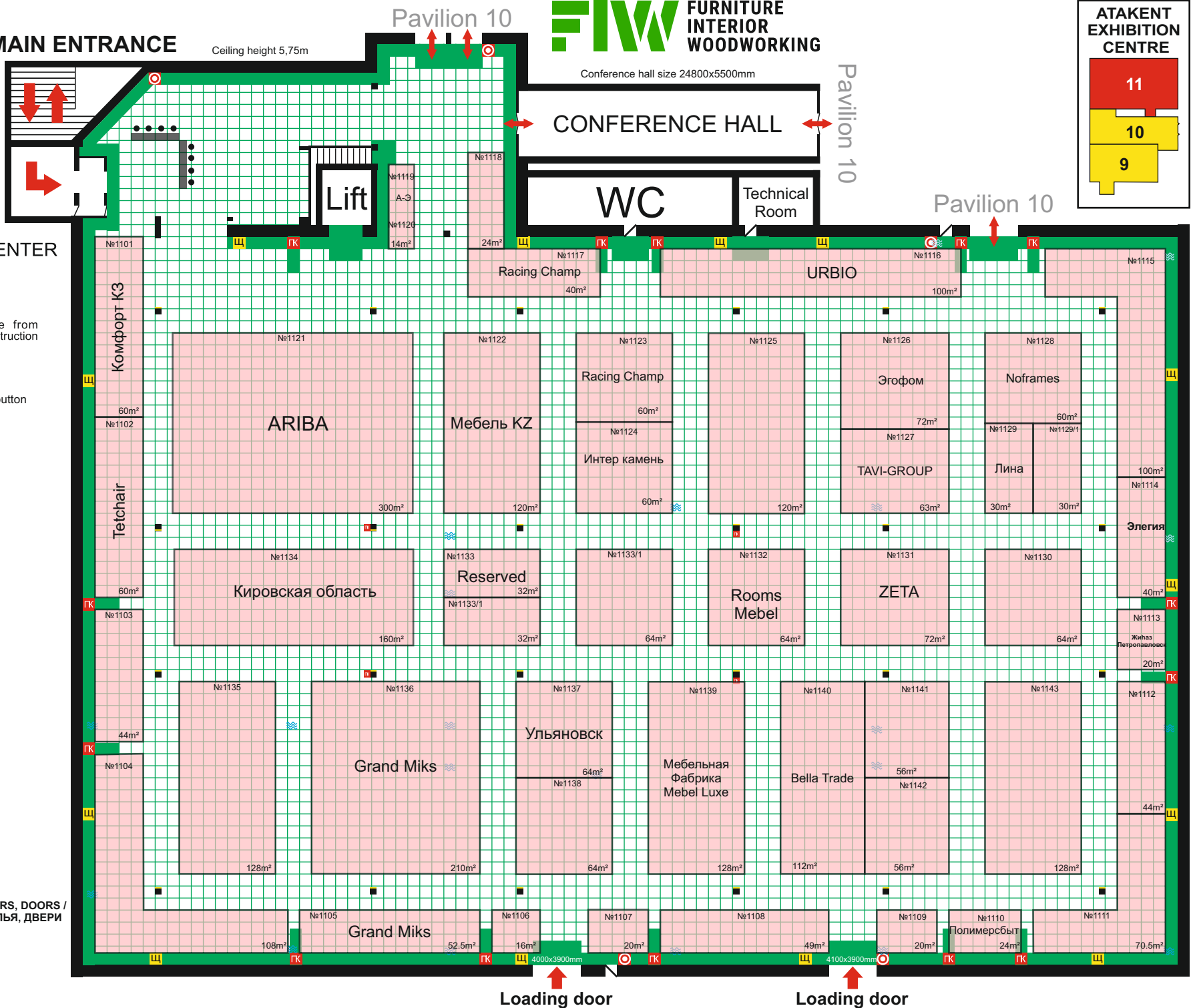

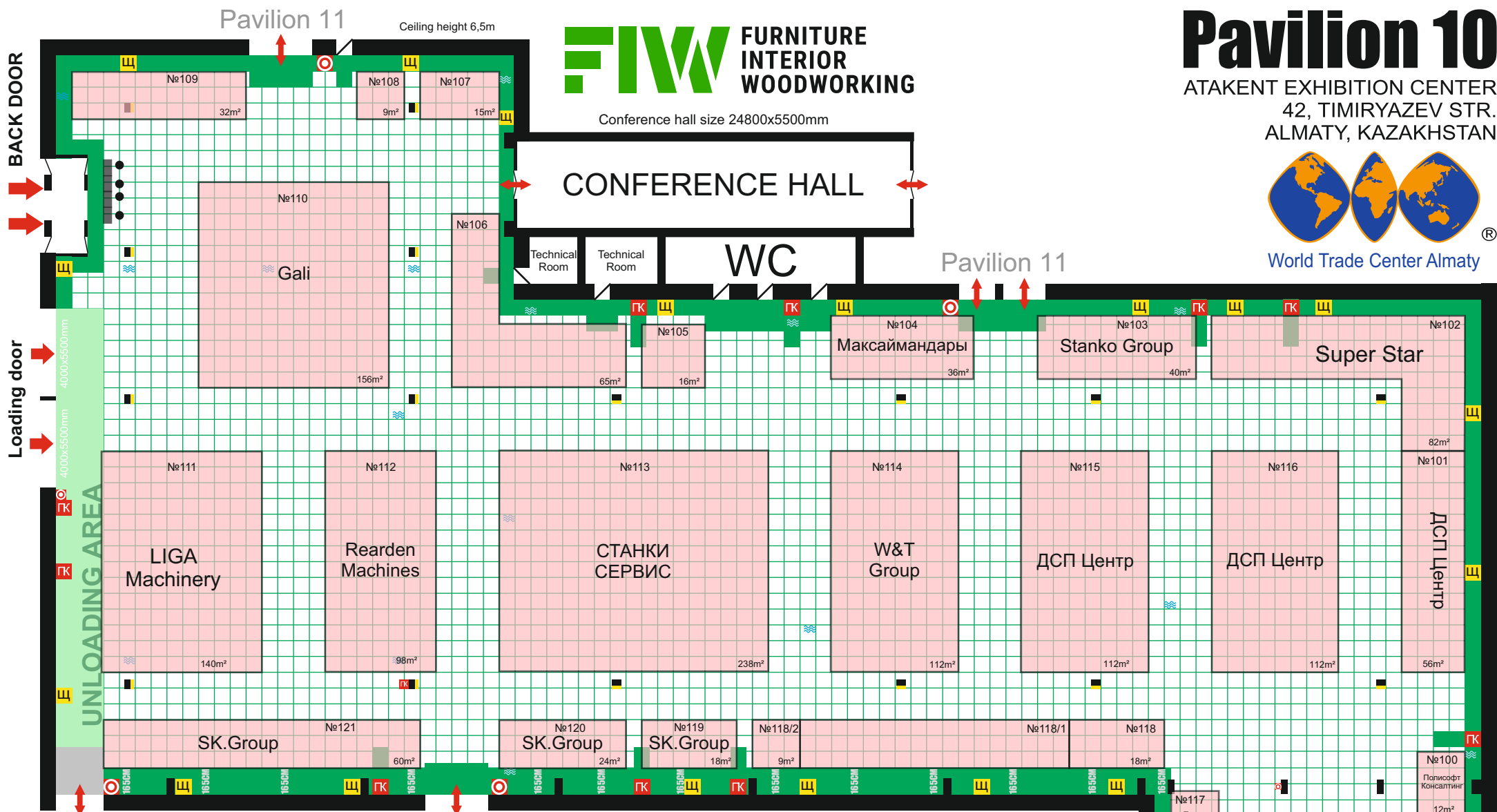

**FIW FURNITURE INTERIOR WOODWORKING**

Conference hall size 24800x5500mm

# Pavilion 10

ATAKENT EXHIBITION CENTER  
42, TIMIRYAZEV STR.  
ALMATY, KAZAKHSTAN



World Trade Center Almaty

- MATTRESS & TEXTILE / МАТРАСЫ И ТЕКСТИЛЬ**
- COMPONENTS & ACCESSORIES, FASADES / ФУРНИТУРА И КОМПЛЕКТУЮЩИЕ, ФАСАДЫ**
- FREE BOOTH / СВОБОДНАЯ ПЛОЩАДЬ**

Нажмите, чтобы заказать эксклюзивный стенд

Click to order Exclusive stand

- 1 square meter on the floorplan
- Free zone from booth construction
- Electrical shield
- Fireplug
- Pillar 60x60cm
- Signaling button
- Plumbing

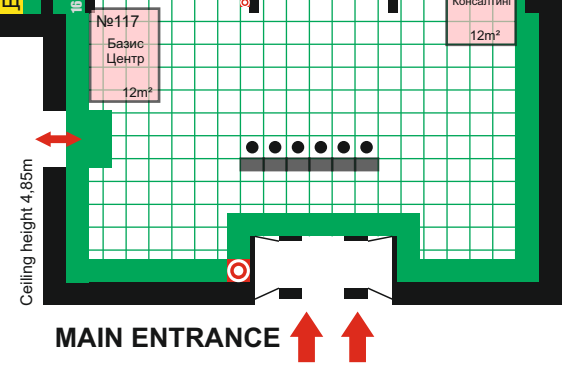
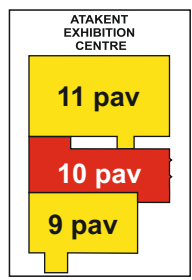
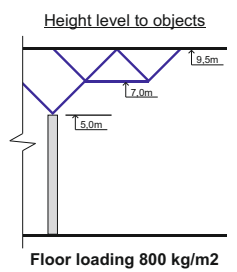

# Pavilion 9

ATAKENT EXHIBITION CENTER  
42, TIMIRYAZEV STR.  
ALMATY, KAZAKHSTAN

**FIW** FURNITURE  
INTERIOR  
WOODWORKING





# Pavilion 9 2nd floor

ATAKENT EXHIBITION CENTER  
42, TIMIRYAZEV STR.  
ALMATY, KAZAKHSTAN



World Trade Center Almaty

 1square meter  
on the floorplan

 Free zone from  
booth construction

 Fireplug

Ceiling heights 4,9m

Floor loading 800 kg/m<sup>2</sup>

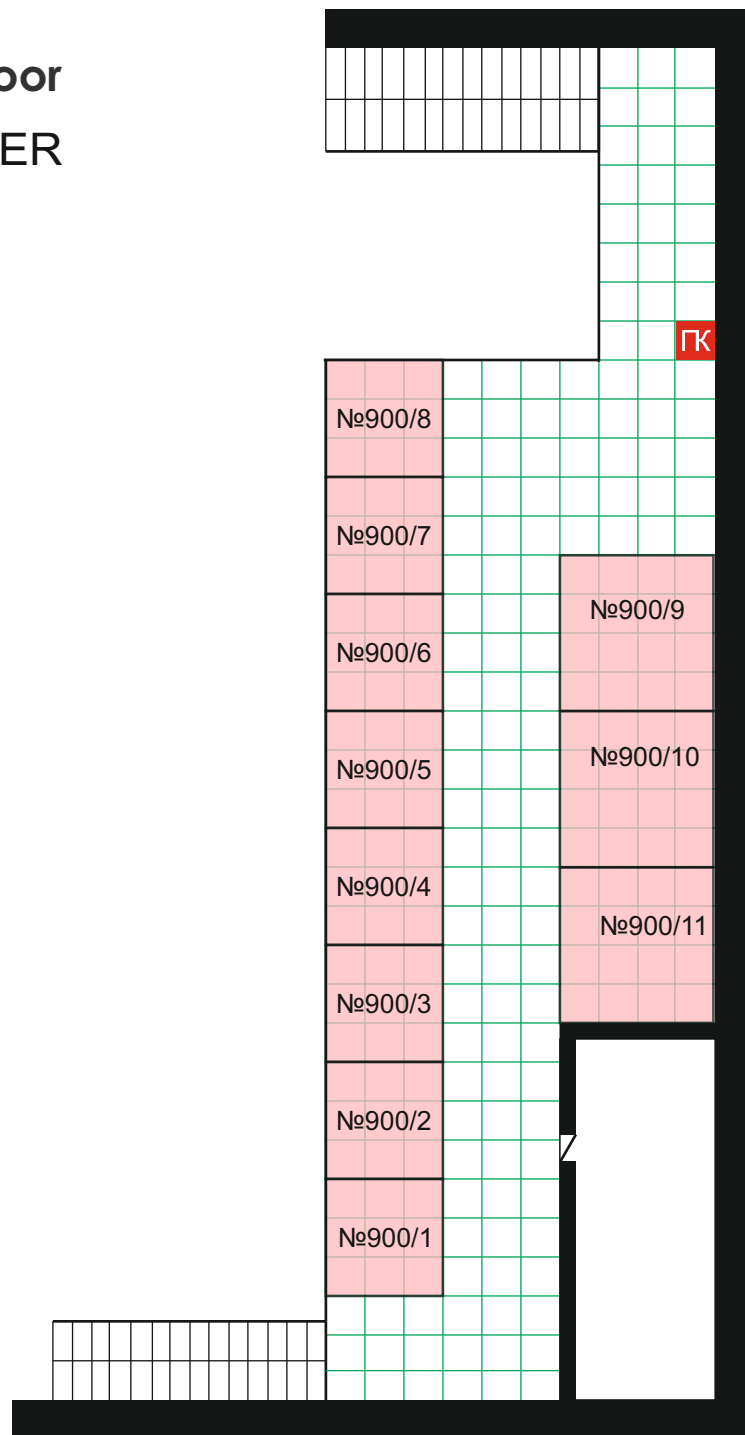
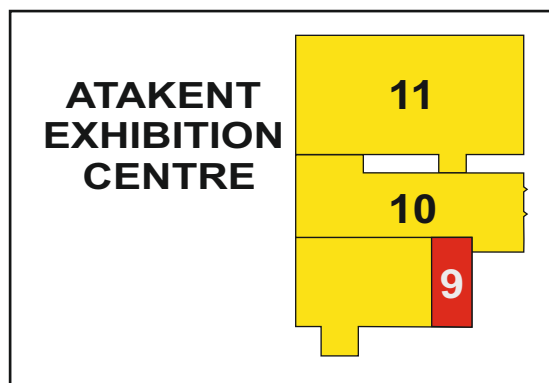



ATAKENT EXHIBITION CENTER  
42, TIMIRYAZEV STR.  
ALMATY, KAZAKHSTAN

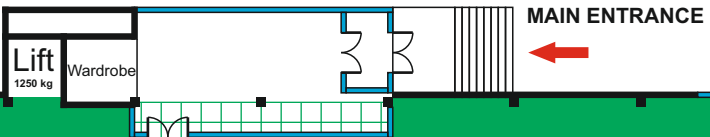

Pavilion 7



Pavilion 8



- 1 square meter on the floorplan
- Free zone from booth construction
- Pillar 55x55cm
- Fireplug
- Electrical shield
- Signaling button
- Plumbing

MAIN ENTRANCE

